

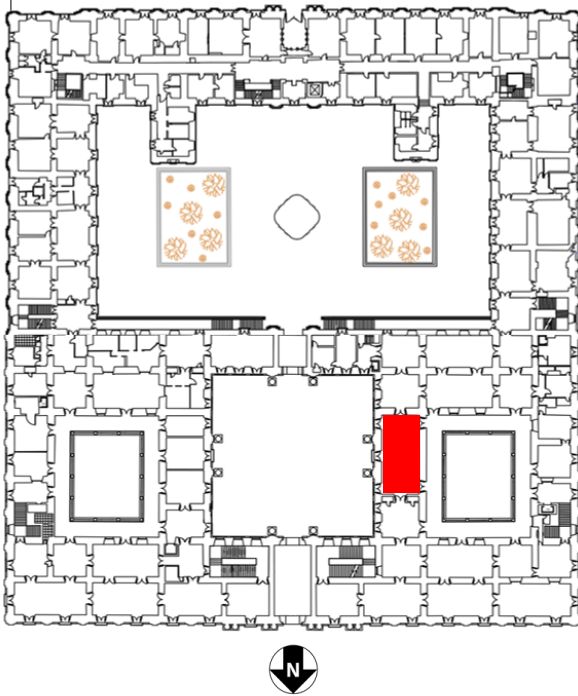



## PARAMETROS ADECUADOS DE ONDAS LUMÍNICAS PARA LOS BIENES PATRIMONIALES DEL PALACIO DE LA MONEDA

### PLANIMETRÍA SEGUNDO PISO





### SIMBOLOGÍA

-  Ubicación del salón dentro del Palacio
-  Pintura de caballete: 150 Lux (sensibilidad media)
-  Madera: 150 Lux (sensibilidad media)
-  Textil: 50 Lux (sensibilidad alta)

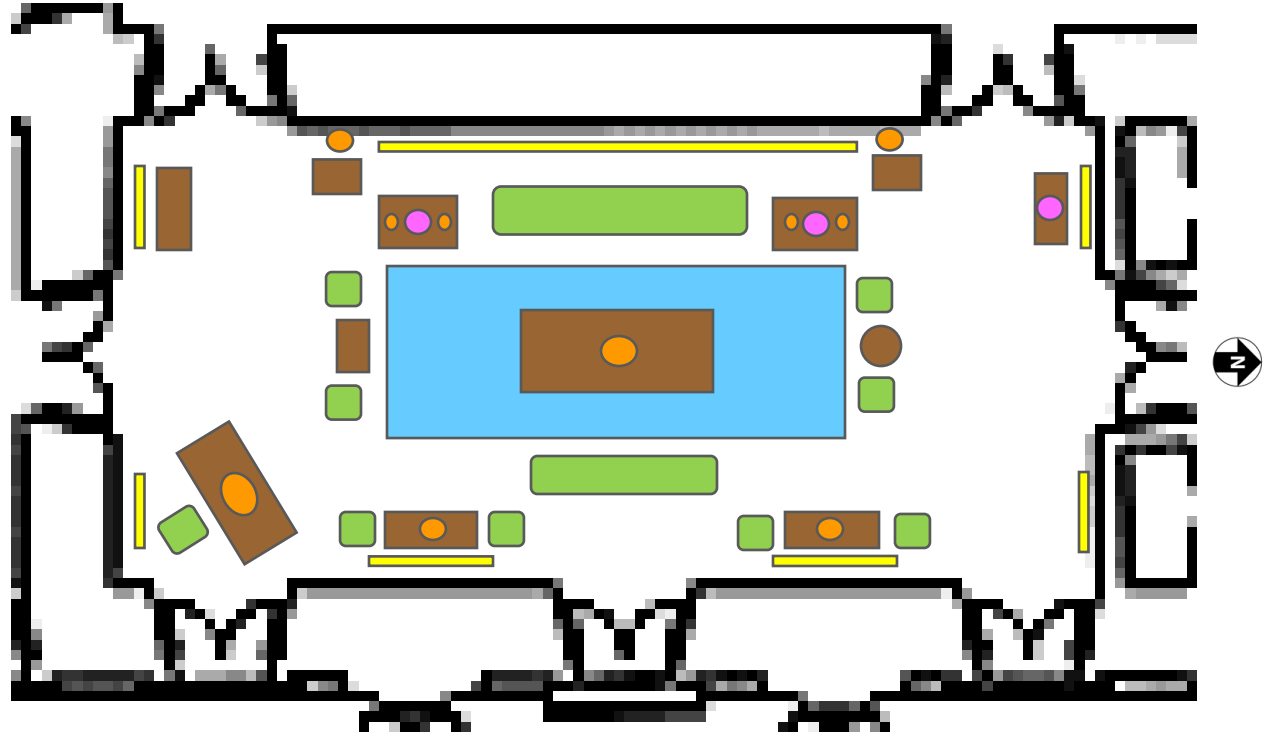
### SALÓN AZUL



-  Mobiliario, madera y textil: 150 Lux (sensibilidad media)
-  Metal: 300 Lux (no sensible)
-  Cerámica: 300 lux (no sensible)